

AMEX SANIVAR

Specifications SaniTube®

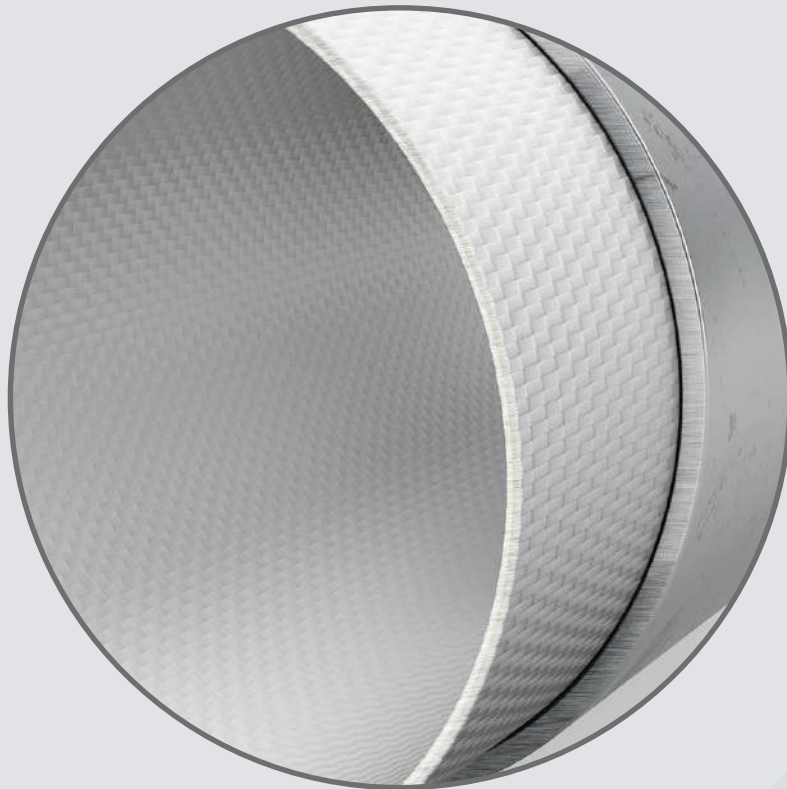

Amex Sanivar AG
Neustraße 19
4623 Neuendorf / Switzerland
T +49 171 610 11 31
M sales@amex-sanivar.com

AMEX SANIVAR

Specifications

SaniTube®

Application for SaniTube®



SaniTube® consists of a resistant polyester-yarn textile liner with a polyurethane or polyethylene coating. SaniTube® is pulled into the host pipe and secured using SaniGrip® couplings. SaniTube® can be used in various pipe materials: steel, cast iron, ductile iron, steel reinforced concrete, in-situ concrete, asbestos cement, PVC, AZ, GRP, clay, PP, and PE. It is also applicable in various shapes of pipes: circular, elliptical, angular, mouth, and squared. SaniTube® can also be used with potable water, industrial water, sewage, gas, oil, and other petrochemicals.

Product name

SaniTube®

Lining material	PET-multifilament yarn
Coating material	Polyethylene / polyurethane
Diameter	DN80 - 450
Installation length (max)	1500m
Installation time (max)	2-5 metres/minute
Installation method	Pull-in
Curing method	N/A
Curing time (max)	N/A
Burst pressure	>25 bar
Bends	45°
Ending	SaniGrip®

Tests and approvals

Potable water	DVGW, KTW, ACS, Hygene Institute Moscow, WRAS, Israel
Gas	DVGW, SVGW
Quality management	ISO 9001
Environmental management	ISO 14001
Burt test	DIN 14811
Abrasion resistant	DIN EN 14811:2008-01
Jet Fuel, oil, diesel, and petrol resistance test	ASTM D2624 , ASTM D130, ASTM D3241

Technical data of textile liner

Melting point {ISO 3146}	250 - 260°C
Density	1,38 g/cm ³
Outside ignition temperature {ISO 871}	> 400°C
Self-ignition temperature {ISO 871}	> 500°C
Decomposition temperature	> 280°C
Tensile strength, longitudinal {ISO 527}	1000 - 2000 N/cm
Tensile strength, radial {ISO 527}	800 - 2000 N/cm
Elongation at break, longitudinal {ISO 1421}	20 - 30 %
Elongation at break, radial {ISO 1421}	40 - 60 %

Hydronic properties liner

OUTER DIAMETER [MM] *[1]

	S*(2)	0 BAR	1 BAR	5 BAR	10 BAR	15 BAR	20 BAR	MASS [G/M]
80 MM	2,6 - 3,0	78,0	80,2	85,2	90,0	96,0	101,0	CA. 780 G/M
100 MM	2,5 - 2,6	96,0	97,0	99,0	104,9	111,2	116,0	CA. 700 G/M
150 MM	2,7 - 2,9	142,0	144,0	149,4	158,9	167,8	172,9	CA 1.200 G/M
200 MM	3,6 - 3,8	197,0	189,0	197,0	204,0	214,0	220,3	CA. 2.800 G/M
250 MM	~ 4,5	237,0	238,7	240,7	245,4	254,5	263,6	CA. 3000 G/M
300 MM	4,7 - 5,1	281,0	285,8	301,4	353,3	373,1	413,8	CA. 2500 G/M
400 MM	~ 4,5	375,6	380,1	412,9	456,4	502,2	BURST 18 BAR	CA. 2500 G/M

(1) Tolerance +/- 1/2mm for up to DN 200 and +/-2/3mm for DN 300 and 400

(2) Wallthickness of liner +/-0,3/0,4mm

Chemical resistancies water

Drinking water	resistant
Supply water	resistant
Process water	resistant
Treated water	resistant
Sea water	resisant
Industrial water	examination technical department
Saturated brine	resistant
Chlorine water (2.5ppm)	resistant
Sewage	resistant

Chemical resistancies oil

Diesel	resistant
Kerosine	resistant
Heavy oil	resistant
Avgas	resistant
Hydraulic oil	resistant
Crude oil	examination technical department
Heating oil	examination technical department
Modgas	not resistant
Biodiesel	not resistant
Gasoil	examination technical department
Pygas	examination technical department
Chlorine Water (1.5ppm chlorine)	resistant

Chemical resistancies fas

Natural gas	resistant
Coke oven gas	resistant
Methane	resistant
Propane	resistant
Butane	resistant
Hydrogen	resistant
Nitrogen	examination technical department
Carbon dioxide	resistant
Carbon monoxide	resistant
Oxygen	resistant
Hydrogen sulphide	not resistant
Biogas	not resistant

Connecting technologies



SaniGrip®

For connecting SaniTube® to the host pipe, we use our SaniGrip® coupling. This coupling is made of stainless steel and coated with a potable water, gas, oil, and sewage approved coating. Its operating pressure is PN 16.

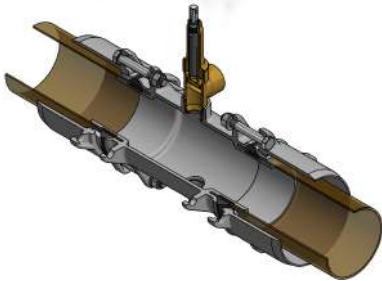

SaniGrip® House Connection

In the case of reconnecting house connections with SaniTube®, the host pipe is cut, and our house connection coupling is attached to SaniGrip® on one side, and the host pipe on the other.



Multi Grip

Multi Grip uses an EPDM or NBR gasket. Maximum operating pressure is 16 bar with the Angular deviation at a max. of 4°.

Technical data connecting technologies

TECHNICAL DATA SANIGRIP®

Rivet water	Stainless Steel
Rivet gas	NBR
O-ring material	EPDM/NBR
Hexagon nut	ISO 4032
Washer	ISO 7089
Pressure flange	EN-GJS-500-7
Cone ring	Thermoplastic

	DIAMETER BOLT [MM]	WEIGHT [G/M]	BOLT SPECS
80 MM	190.0	9.00	M16
100 MM	220.0	11.37	M16
150 MM	285.0	16.28	M16
200 MM	340.0	21.59	M20
250 MM	405.0	28.00	M20
300 MM	460.0	38.00	M20
400 MM	580.0	63.00	M20